

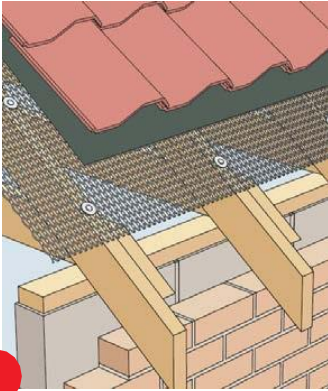

## Expanded Metal Mesh Application

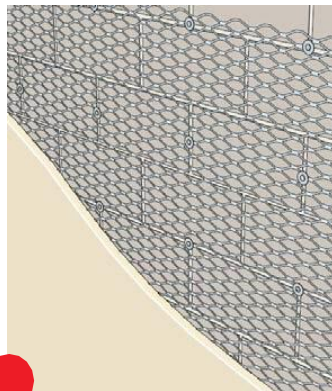

A Security mesh for roofs



B Security mesh for masonry

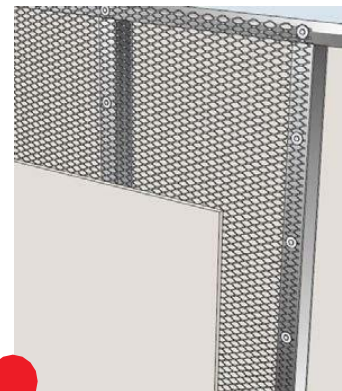

C Security mesh for metal stud walls

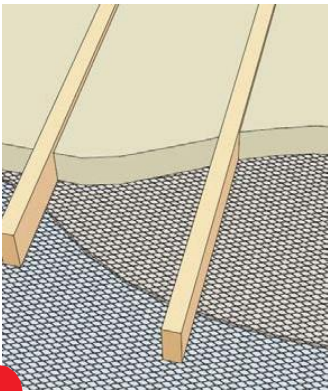

D Security mesh for ceilings and render

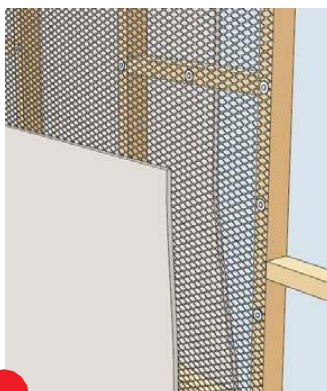

E Security mesh for timber stud walls

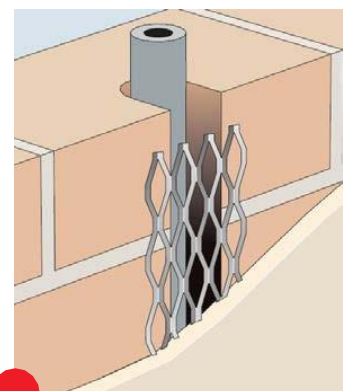

F Strip mesh reinforcement for plaster

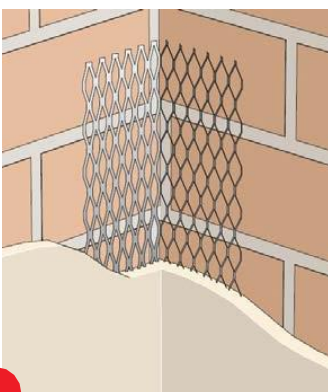

G Corner mesh for reinforcing internal and external corners and at window

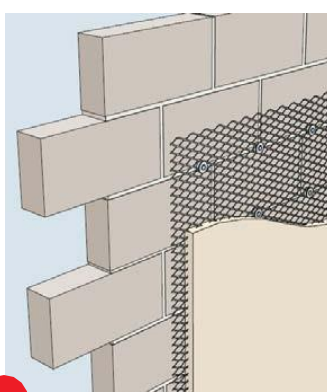

H Carrier for plaster and render finishes

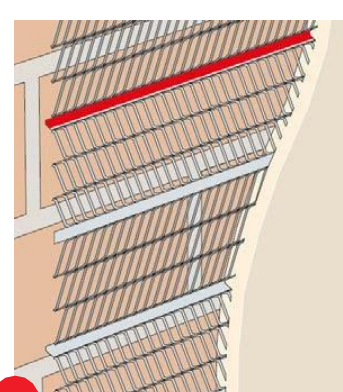



I Carrier for plaster and render finishes



**唯佳金属网**  
WEIJIA METAL MESH

**Hebei Weijia Metal Mesh Co.,Ltd**

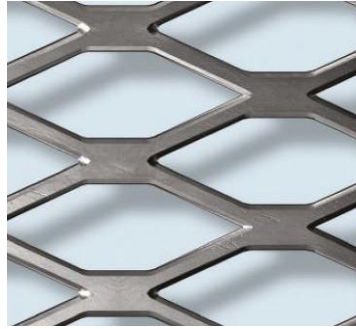
Curtain Wall Mesh / Perforated Metal Sheet / Steel Grating

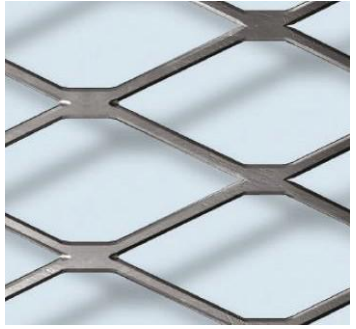
		
Security Mesh Galvanized Steel Security Mesh Mild Steel Applications: <b>ACDE</b>	Security Mesh Galvanized Steel Security Mesh Mild Steel Applications: <b>B</b>	Security Mesh Galvanized Steel Security Mesh Mild Steel Applications: <b>ACDE</b>

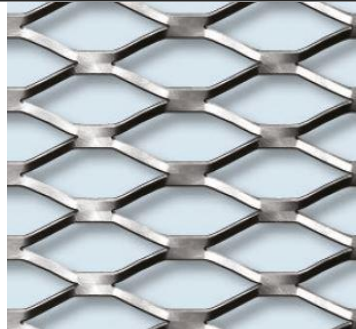
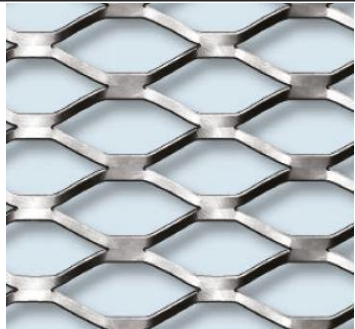
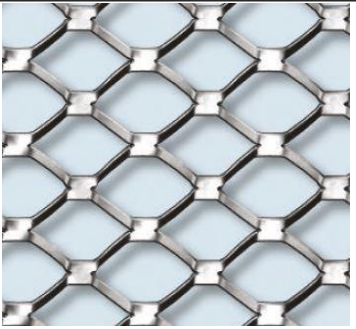
		
Pre-galvanized Steel Pre-galvanized Steel Applications: <b>FG</b>	Lathing Pre-galvanized Steel Lathing Stainless Steel Applications: <b>FH</b>	Lathing Pre-galvanized Steel Lathing Pre-galvanized Steel Lathing Pre-galvanized Steel Applications: <b>H</b>

Hebei Weijia Metal Mesh Co.,Ltd was established in 2008. It covers an area of more than 10000 square meters. There are more than 2000 employees and Senior technicians and engineers more than 300. We are a research, development, production, sales and service of high-tech enterprises, who is metal mesh the first mover in China.

Expanded mesh curtain wall is everlasting, and it is widely used in machine guards, animal cages, the protecting of electrical equipment window, safety door & window, room dividers, decorative ceiling, highway fence, civil building. Concrete in for cement, Walkway, And so on.

<https://www.wjmetalmesh.com> | +86-13231127750